

Information for Participants

1. Venue Information

- To avoid congestion on the day, please complete **pre-registration** in advance.
- Payment on site will also be available **online by credit card only**.

(1) Opening Hours

- **Saturday, November 1:** 8:00 – 18:40
- **Sunday, November 2:** 8:20 – 17:10

Please enter the venue from the main entrance and proceed upstairs.

(2) Registration Fees and Period

One registration grants access to all programs of:

- The 33rd Annual Meeting of the Japanese Vascular Biology and Medicine Organization (JVBMO 2025)
- The 6th Asia-Australia Vascular Biology Meeting (AAVBM 2025)

	Early Bird rate 【JPY】 ends 23 October 2025	Regular rate 【JPY】 0:00 on November 1 (Sat) until 15:00 on November 2 (Sun)
Standard	¥13,000	¥15,000
Undergraduate/Medical Student	¥3,000	¥5,000

* Please register with your expected status at the time of the meeting.

* Undergraduate/Medical students are to email a valid student ID to jvbmo2025@zenith-j.co.jp

(3) Participant Badge

- Your participant badge will be uploaded to your My Page one week before the meeting.
- Please download and print it (A4 size) and bring it with you to the venue.
- Place your badge in the name holder provided at the venue and wear it at all times during the meeting.
- If you cannot print the badge yourself, please visit the Information Desk for assistance.
- Staff may ask you to show your badge if it is not clearly visible.

(4) On-site Registration

- On-site registration is available from **0:00 on November 1 (Sat) until 15:00 on November 2 (Sun)** via online credit card payment.
- At arrival, please present your payment record at the Information Desk (available at the bottom of the “Payment” page in your My Page).
- Undergraduate/Medical Student must also present valid ID.
- Once payment is confirmed, a badge will be issued. Please write your name and affiliation, and wear your badge at all times inside the venue.

(5) Receipt

Receipts can be downloaded from the “Payment” page in your My Page after completing the online registration payment.

(6) Program & Abstract Book

- Printed abstract book will **not** be provided.
- PDF version will be available for download in your My Page. You may print it yourself or view it on your device.
- The PDF will be uploaded **two weeks before the meeting** and will be accessible only to participants who have completed payment.

2. Other Reception Services

(1) Information Desk

General inquiries will be handled here.

(2) Cloakroom

- Items can be stored only during designated hours each day. Overnight storage is **not available**.
- Valuables, laptops, fragile items, and umbrellas cannot be accepted.

Opening hours:

- **Saturday, November 1:** 8:00 – 18:40

Participants attending the Reception Party are requested to pick up their belongings before going to the reception venue. A cloak area will be provided at the party venue.

- **Sunday, November 2:** 8:20 – 17:10

3. Poster Sessions

Location: B1 Poster Session Room (Collaboration Space)

• Viewing Hours:

- Saturday, November 1: 10:00 – 17:00

Poster Session: 17:00 – 18:30

- Sunday, November 2: 8:20 – 12:00

We will adopt a free discussion style.
The following presenters will stand in front of their panels:

• 17:00–17:30: Presenters with odd presentation numbers

• 17:30–18:00: Presenters with even presentation numbers

• 18:00–18:30: Free discussion

4. Corporate Exhibits

Location: 1F Foyer

• Saturday, November 1: 8:00 – 17:00

• Sunday, November 2: 8:20 – 16:00

5. Luncheon Seminars

As these seminars are held as part of the 33rd JVBMO Annual Meeting, presentations and slides will generally be in Japanese.

6. General Information

(1) Wi-Fi

• SSID: Hongo-Guest

• Password: hongo-guest00

No limit on connection time or number of logins.

(2) Lounge for Participants

• Location: B1 Multipurpose Space

• Vending machines are available in the B1 Lounge.

(3) Lost & Found

• Items will be kept at the Information Desk.

(4) Announcements

• No information boards will be provided.

• Staff cannot relay personal messages. Please contact each other directly.

(5) Copy/Print Services

• Not available at the venue.

7. Requests to Participants

• Smoking is **prohibited throughout the premises** (no smoking areas provided).

• Mobile phone use inside lecture rooms is strictly prohibited.

• Unauthorized photography, video recording, and audio recording inside the venue are strictly prohibited.

8. Invitation to the JVBMO 2025 & AAVBM 2025 Joint Reception

We are pleased to announce that the Joint Reception of JVBMO 2025 and AAVBM 2025 will be held on the first day of the meeting, Saturday, November 1, 2025.

We warmly invite many of you to take part in this networking opportunity.

Date & Time:

Saturday, November 1, 2025, 18:30–20:00 (Reception opens at 18:00)

Venue:

Building No.7, Juntendo University Hongo-Ochanomizu Campus

Fee:

• Meeting registrants: JPY 3,000

• Accompanying persons / Reception-only participants: JPY 6,000

【How to Register】

To ensure smooth arrangements, we kindly ask for your cooperation in pre-registration.

Pre-registration period: September 1 (Mon) – October 15 (Wed), 2025

* Please confirm on-site registration at the Information Desk.

* We do not accept any refunds after registration. Please check your schedule, travel arrangements, and other necessary details before completing your registration.

会場アクセス / Access Guide

順天堂大学 本郷・お茶の水キャンパス 7号館 小川秀興講堂
 東京都文京区本郷2丁目2-5
 Ogawa Hideoki Hall, Bldg. 7, Juntendo University (Hongo-Ochanomizu Campus)
 2-2-5 Hongo, Bunkyo City, Tokyo 113-8421, Japan

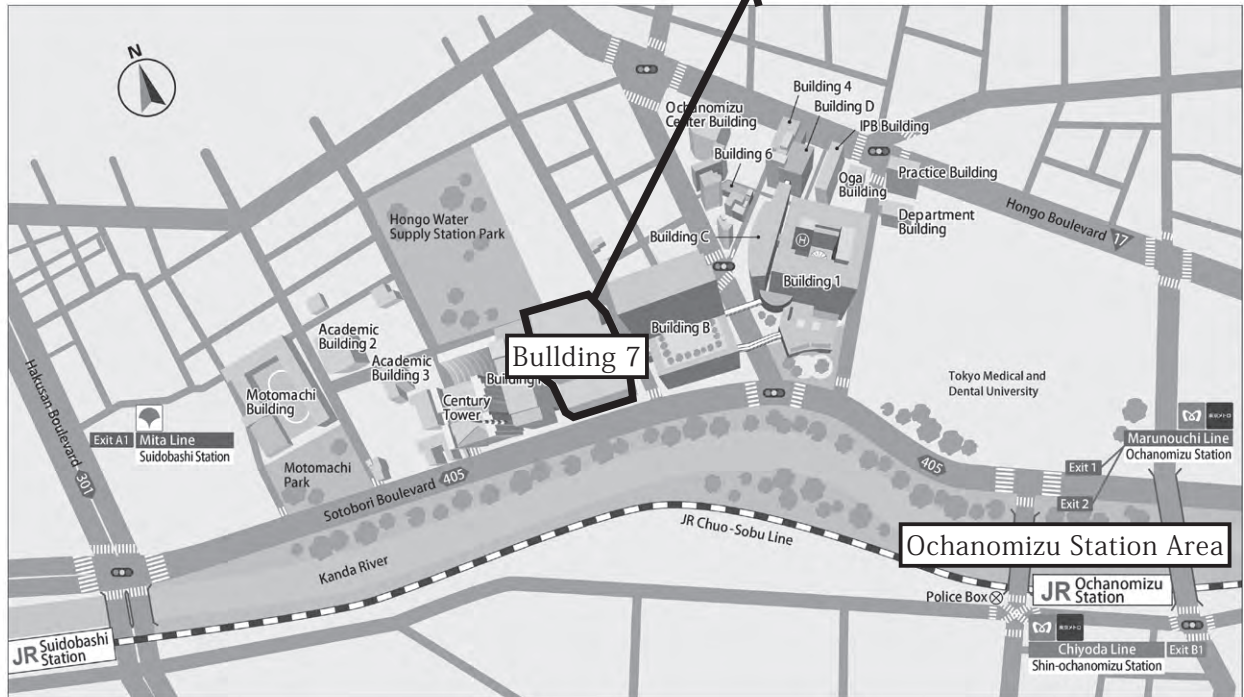
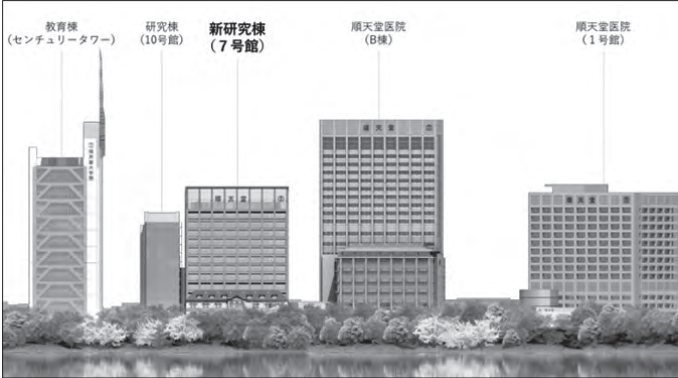

※階段を上ってメインエントランスよりご入場ください。

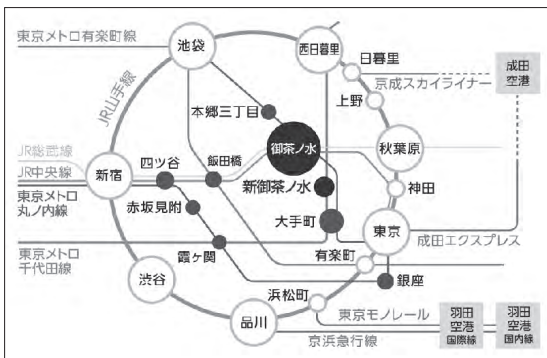

JR線「御茶ノ水」駅下車(御茶ノ水口)……………徒歩7分
 東京メトロ(丸の内線)「御茶ノ水」駅下車……………徒歩7分
 東京メトロ(千代田線)
 「新御茶ノ水」駅下車(B1出口)……………徒歩9分

Access:

- JR Chuo-Sobu Line < 03 18 Ochanomizu Station, Ochanomizu-Bashi Exit >: 7-minute walk
- Tokyo Metro Marunouchi Line < M20 Ochanomizu Station, Exit 1 or 2 >: 7-minute walk
- Tokyo Metro Chiyoda Line < 12 Shin-ochanomizu Station, Exit B1 >: 9-minute walk
- JR Chuo-Sobu Line < 17 Suidobashi Station, East Exit >: 8-minute walk
- Toei Subway Mita Line < 11 Suidobashi Station, Exit A1 >: 8-minute walk

Floor Guide

順天堂大学 本郷・お茶の水キャンパス 7号館 小川秀興講堂 /
 Ogawa Hideoki Hall, Bldg. 7, Juntendo University (Hongo-Ochanomizu Campus)

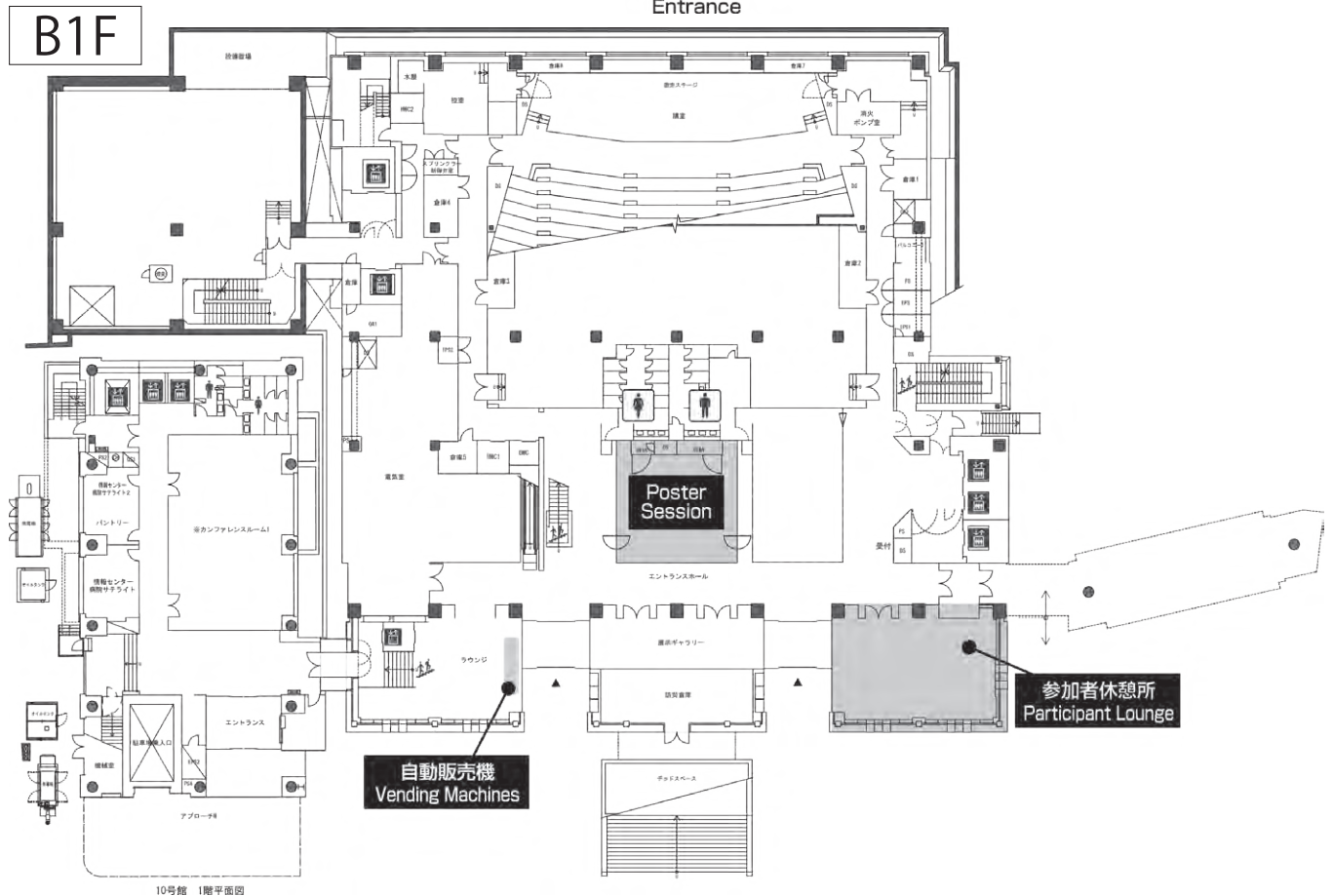
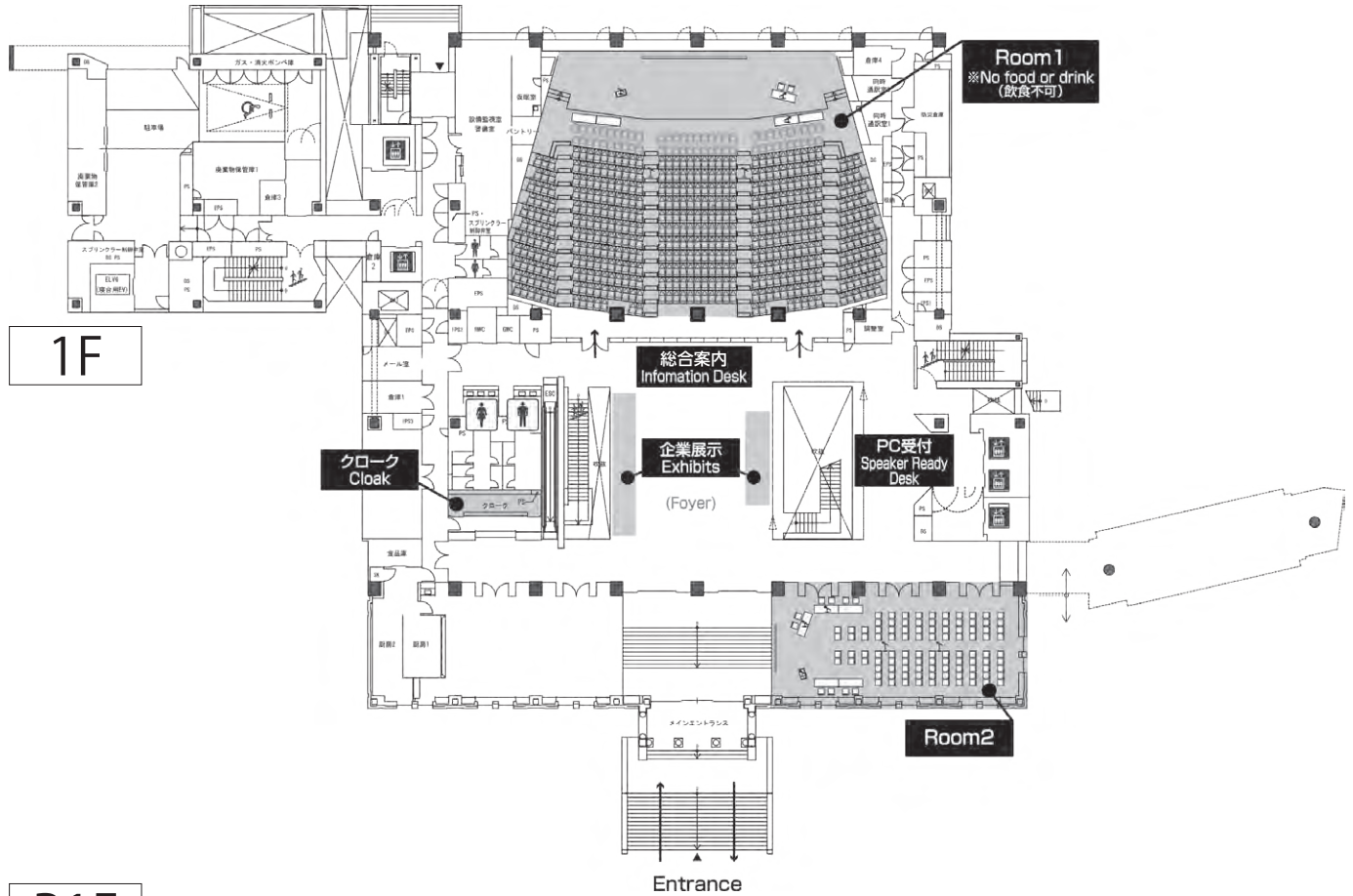

9F

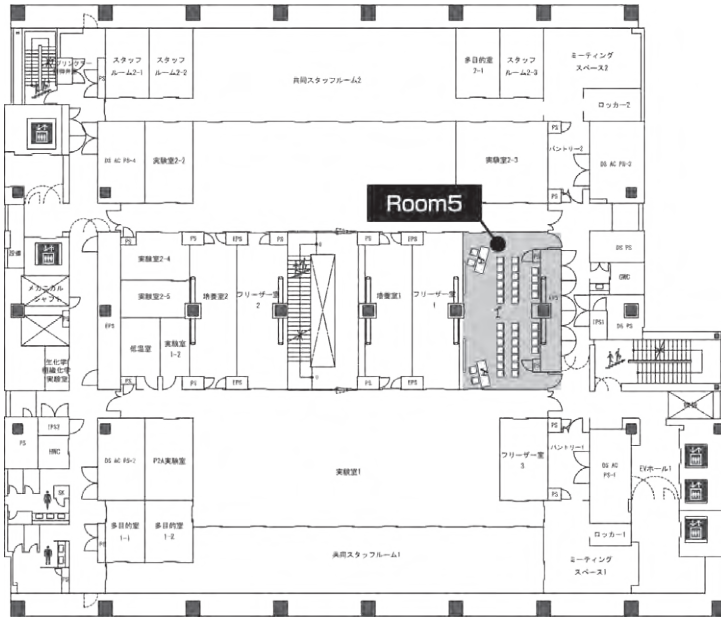

8F

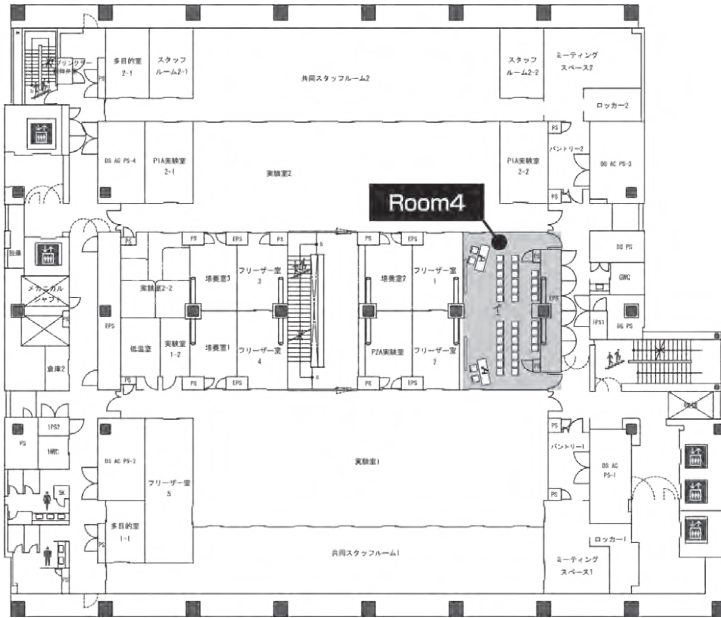

7F

